

LOWER LEVEL

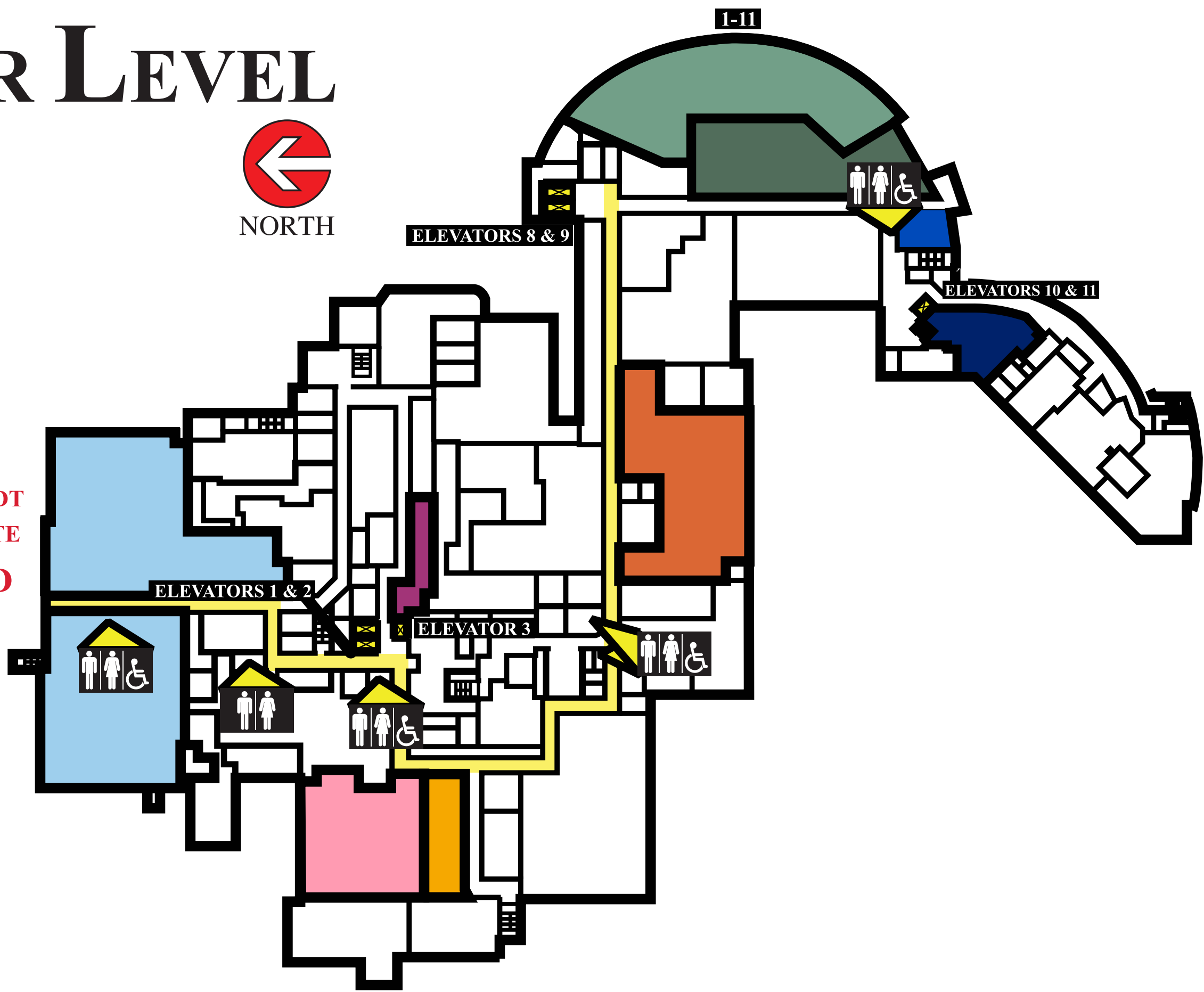

NORTH

**DREILING-SCHMIDT
CANCER INSTITUTE
ENTRANCE D
PARKING
LOT D**



- | | | |
|--------------------------------------|----------------------|--------------------------------------|
| CAFETERIA | MATERIALS MANAGEMENT | PATIENT ROOMS 1-11 |
| DREILING-SCHMIDT
CANCER INSTITUTE | RETAIL PHARMACY | ST. AGNES CONFERENCE ROOMS |
| HUMAN RESOURCES | PT/OT SPEECH | WOUND HEALING &
HYPERBARIC CENTER |

ELEVATORS 1, 2 & 3
ACCESS TO PATIENT ROOMS
201 - 249 • 301 - 349 • Cafeteria

ELEVATORS 6 & 7
ACCESS TO PHYSICIAN OFFICES

ELEVATORS 8 & 9
ACCESS TO PATIENT ROOMS
1 - 11 • 1101 - 1112 • 2201 - 2222

ELEVATORS 10 & 11
ACCESS TO DEBAKEY
HEART CLINIC

LEVEL 1



NORTH

**BICKLE PAVILION
ENTRANCE A
PARKING LOT A**

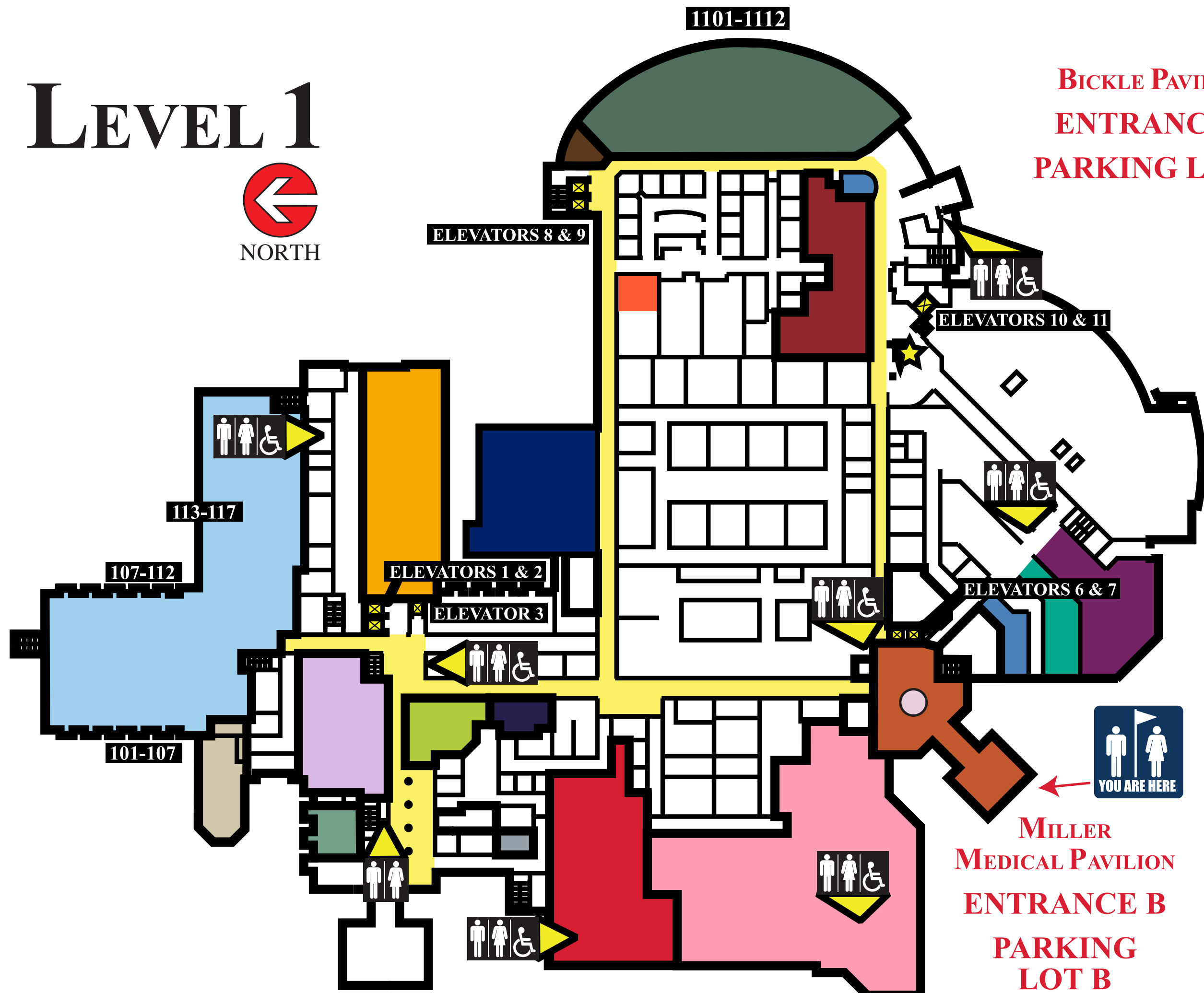

**MAIN ENTRANCE
ENTRANCE C • PARKING LOT C**

**MILLER
MEDICAL PAVILION
ENTRANCE B
PARKING
LOT B**

- | | | |
|---|--|--|
| BATHROOMS | FOUNDATION | NON-INVASIVE CARDIOLOGY
-CARDIAC NUCLEAR MEDICINE
-STRESS LAB
-OPEKG
-OPECHO |
| BREAST CARE CENTER | GIFT SHOP | SECURITY |
| INTENSIVE CARE MEDICAL / SURGICAL
WAITING ROOM | HADLEY CONFERENCE ROOMS | SPECIAL NURSING SERVICES |
| CHAPEL & PASTORAL CARE | CATH LAB WAITING ROOM | STAIRCASE TO
DEBAKEY HEART CLINIC |
| CUSTOMER SERVICE | INTENSIVE CARE MEDICAL / SURGICAL
PATIENT ROOMS 1101-1112 | SURGICAL WAITING |
| DIAGNOSTIC IMAGING
-X-RAY -CT
-MRI -NUCLEAR MEDICINE
-ULTRASOUND -VASCULAR LAB | INFORMATION | WOMEN'S CENTER
OB - PATIENT ROOMS 101-117 |
| EMERGENCY | REGISTRATION / ADMITTING
CASHIER | MILLER MEDICAL PAVILION |

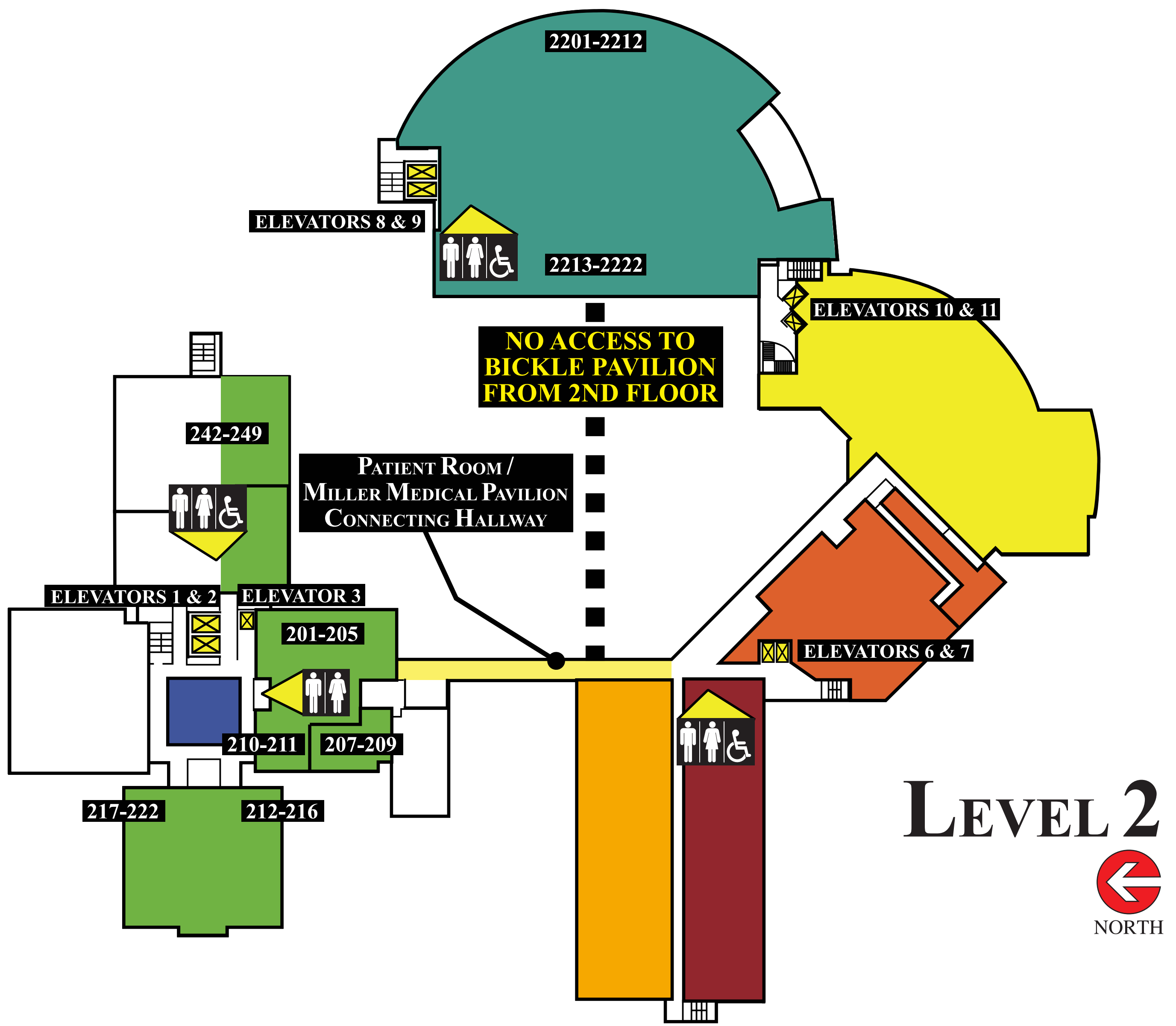

- | | | |
|--|---|---|
| DEBAKEY HEART CLINIC | MEDICAL SPECIALIST SUITE 202 | ACUTE CARE UNIT
PATIENT ROOMS 201-218, 242-249 |
| BICKLE PAVILION - PROGRESSIVE CARE UNIT
PATIENT ROOMS 2201-2222 | PEDIATRIC CENTER SUITE 204 | ACUTE CARE UNIT NURSES STATION |
| NEPHROLOGY CENTER OF WESTERN KANSAS SUITE 202 | THE CENTER FOR WOMEN'S HEALTH SUITE 210 | |

ELEVATORS 1, 2 & 3
ACCESS TO PATIENT ROOMS
201 - 249 • 301 - 349 • Cafeteria

ELEVATORS 6 & 7
ACCESS TO PHYSICIAN OFFICES

ELEVATORS 8 & 9
ACCESS TO PATIENT ROOMS
1 - 11 • 1101 - 1112 • 2201 - 2222

ELEVATORS 10 & 11
ACCESS TO DEBAKEY
HEART CLINIC

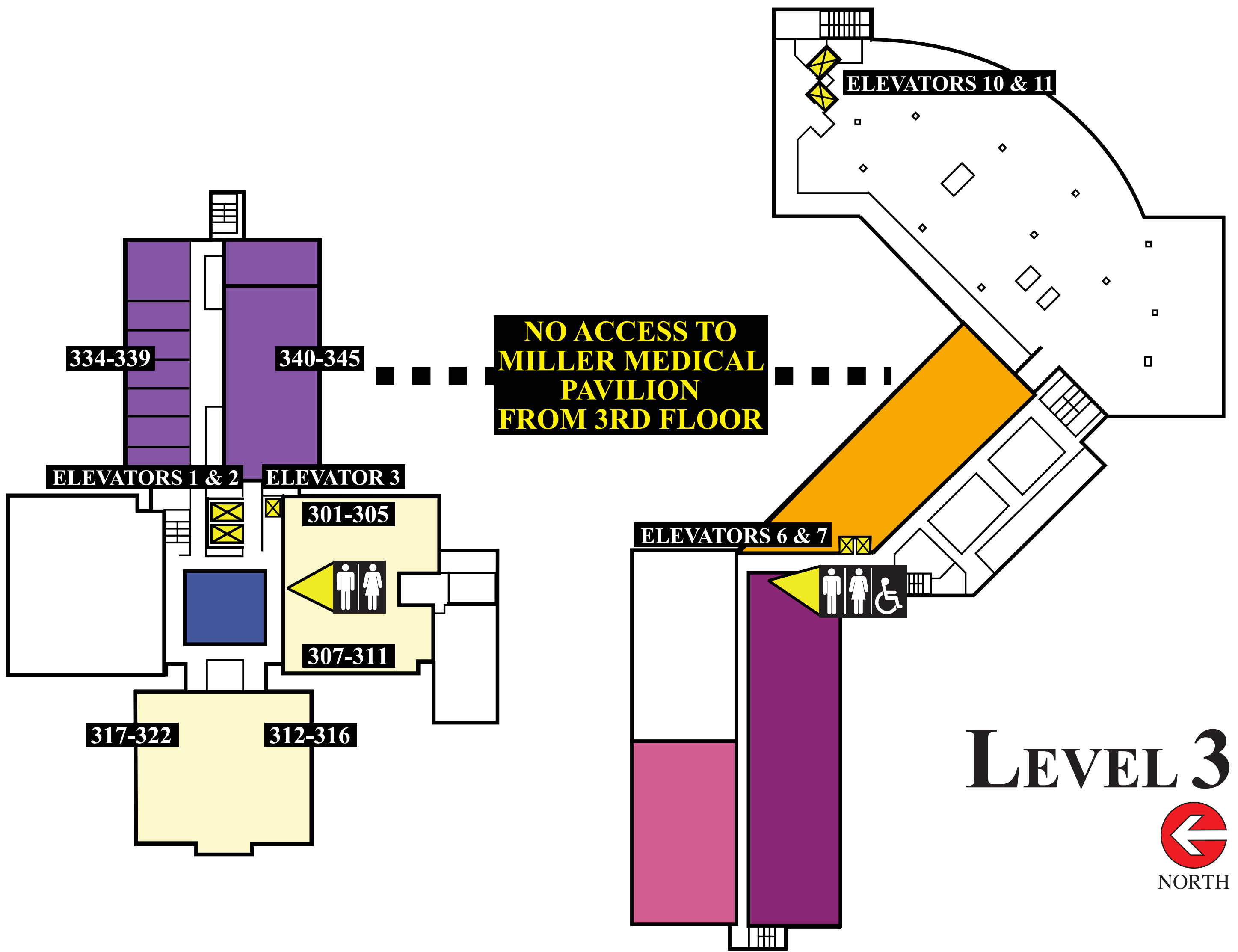

- | | | |
|---|---|--|
| SURGICAL UNIT NURSES STATION | PULMONOLOGY ASSOCIATES OF HAYS, SUITE 300 | EYE SPECIALISTS ASSOCIATED, PA SUITE 312 |
| BONE, JOINT & SPINE CENTER
PATIENT ROOMS 334-345 | HAYSMED PSYCHIATRIC ASSOCIATES SUITE 300 | WESTERN KANSAS UROLOGICAL ASSOCIATES SUITE 308 |
| SURGICAL UNIT
PATIENT ROOMS 301-322 | | |